

TOP SECRET

DESIGN OF THE MONTH WINNER
 BY BRET SIMPKINS
 Albuquerque, New Mexico
 ESTES INDUSTRIES ROCKET PLAN NO. 78

Skill Level 2

★ BUILD THE TOP SECRET WITH ESTES HIGH PERFORMANCE PARTS AND ACCESSORIES

PARTS LIST

- 1 BODY TUBE – BT-20B
- 1 BODY TUBE – BT-5
- 1 NOSE CONE – BNC-20N
- 1 FIN STOCK – BFS-20
- 1 ENGINE BLOCK – EB-20A
- 1 PARACHUTE KIT – PK-8
- 1 SCREW EYE – SE-2
- 1 SHOCK CORD – SC-1
- 1 LAUNCH LUG – LL-2A
- 2 WEIGHTS – NCW-1

ADDITIONAL MATERIALS

- Hobby Knife
- White Glue
- Ruler
- Sanding Material
- Sanding Sealer
- Enamel Paint (Spray)
- Sharp Pencil

RECOMMENDED ENGINES

- A8-3 B6-4 C6-5

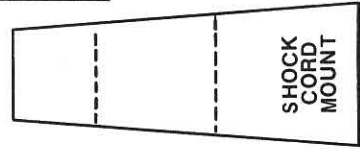
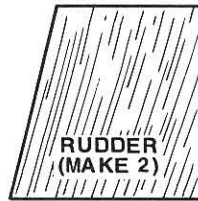
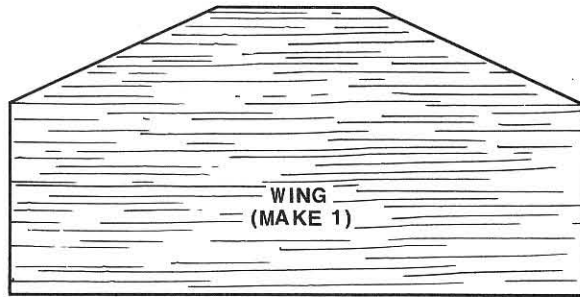
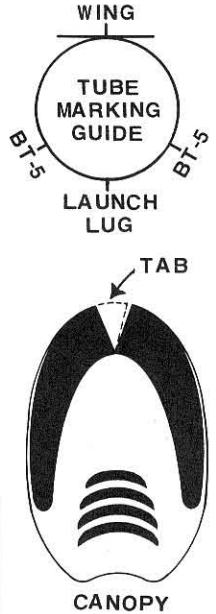

5 a. Trace fin patterns onto balsa sheet as shown in the fin layout.



- b. Glue rudder fins onto wing fin as shown.
- c. After glue dries, sand all areas.
- d. Glue completed wing assembly to BT-20B body tube.

1 a. Cut body tubes to specified lengths.
 BT-20B -- 6 3/4"
 BT-5 -- 2" (Make two).
 b. Mark body tube BT-20B using the tube marking guide. Mark full length of tube with straight lines.

2 a. Using a pencil, make a mark 1/4" from one end of an engine casing.

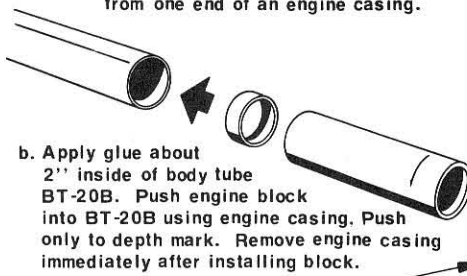

b. Apply glue about 2" inside of body tube BT-20B. Push engine block into BT-20B using engine casing. Push only to depth mark. Remove engine casing immediately after installing block.

3 a. Glue BT-5 body tubes 1/8" from the end of the BT-20B body tube which contains the engine block.
 b. Glue launch lug on BT-20B. 2-1/8" from rear.

4 Assemble parachute kit according to its instructions.

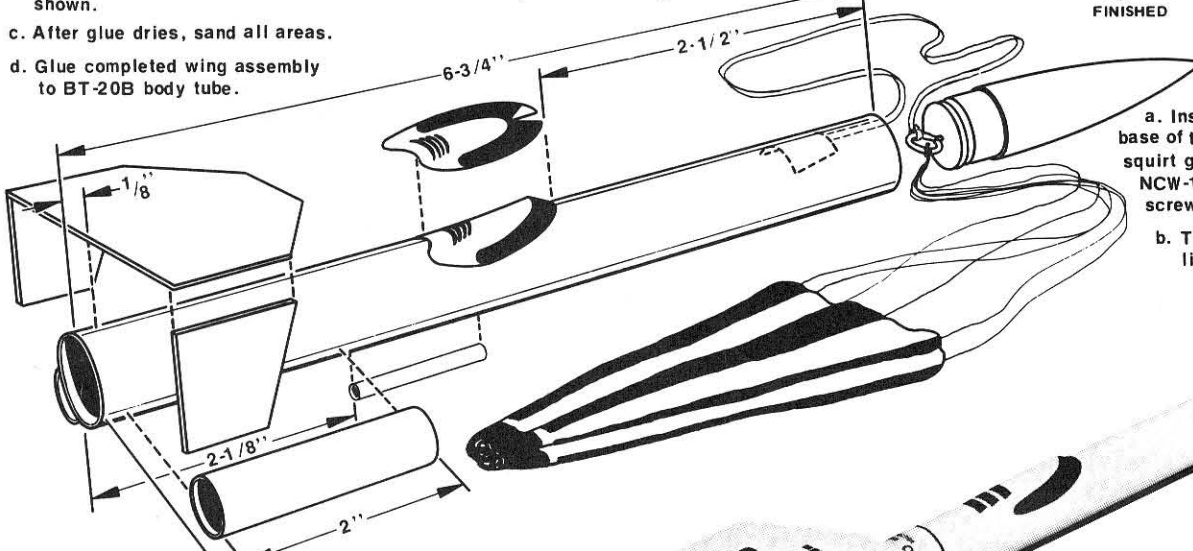
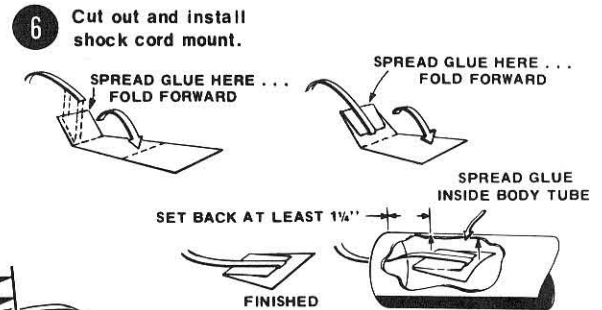

7 a. Insert the screw eye into the base of the nose cone, remove, and squirt glue into hole. Place two NCW-1 nose cone weights on the screw eye and re-insert.
 b. Tie shock cord and shroud lines to the screw eye.

8 a. Cut out canopy and apply glue to tab, bring canopy halves together over tab.
 b. Glue canopy on top of BT-20B body tube 2-1/2" from front.

